

LOCUS MAP
NOT TO SCALE

SEE SPECIAL PERMIT ISSUED BY BOLTON PLANNING BOARD DATED: _____
SEE COMMON DRIVEWAY MAINTENANCE AGREEMENT RECORDED AT W.D.R.D. IN BOOK _____ PAGE _____

COMMON DRIVEWAY PLAN & PROFILE
SHEET 1 OF 2

LOTS 1-4 CENTURY MILL ROAD
BOLTON, MASSACHUSETTS
ASSESSORS MAP 3D PARCEL 75

PREPARED FOR:
21 CENTURY MILL LLC
291 MAIN STREET SUITE 8
NORTHBOROUGH, MA 01532

REV. 11/24/20; 1/9/21; 3/19/21; 4/23/21
DATE: **AUGUST 11, 2020** SCALE: 1" = 30'

ENGINEERING
SURVEYING
PLANNING

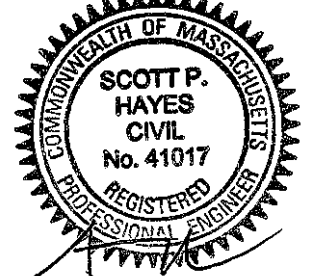

NOTE: TREES TO BE REMOVED FOR COMMON DRIVEWAY CONST. DENOTED WITH 'X' (TYP.)
N/F KEITH M. LUNDBERG & MICHELE A. WADE
28 CENTURY MILL ROAD
MAP 3D PARCEL 28

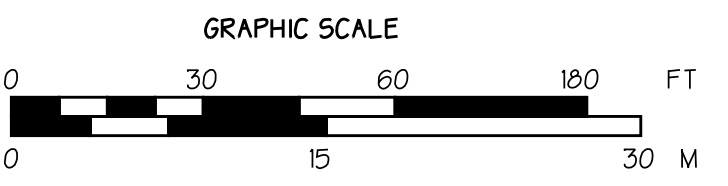

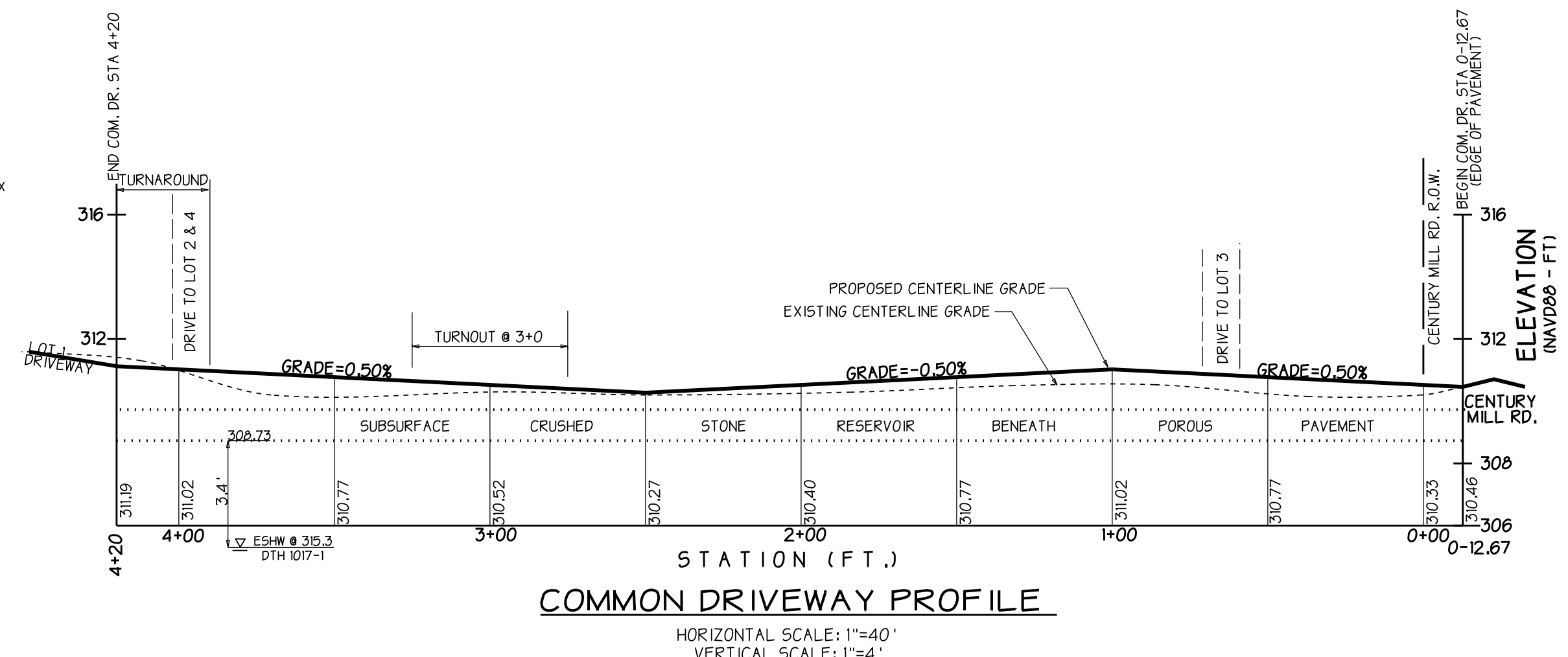
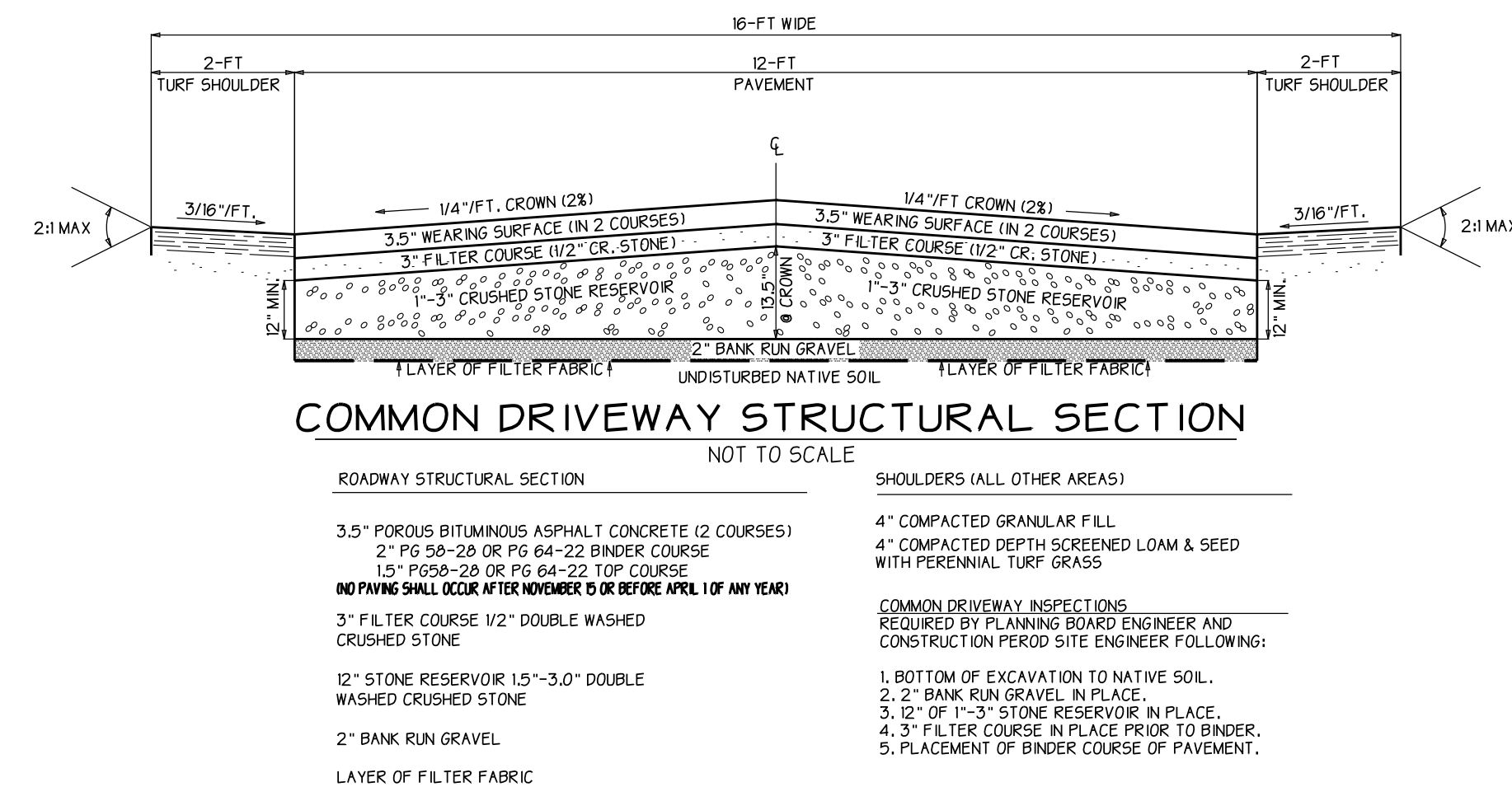
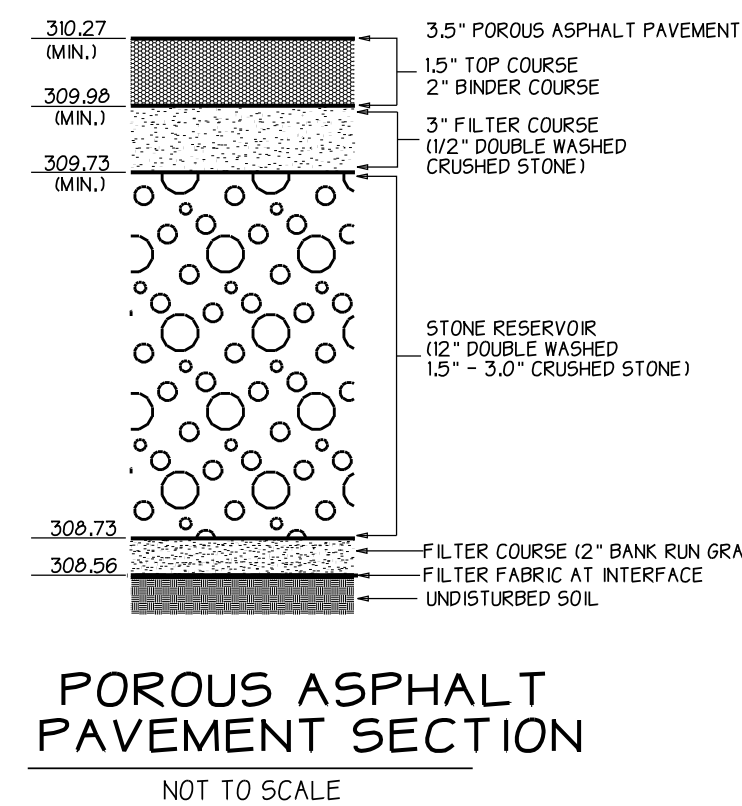

- ### COMMON DRIVEWAY NOTES
- COMMON DRIVEWAY SHOWN IS SUBJECT TO A MAINTENANCE AGREEMENT TO BE RECORDED AT THE W.D.R.D.
 - NO COMMON DRIVEWAYS OR APPROVED OR ACCEPTED PUBLIC WAYS EXIST ON THE SAME SIDE OF CENTURY MILL ROAD WITHIN 200 FEET OF THE PROPOSED COMMON DRIVEWAY CENTERLINE INTERSECTION WITH CENTURY MILL ROAD.
 - PORTIONS OF THE SITE ARE LOCATED WITHIN FEMA DESIGNATED FLOOD ZONE AE. FLOOD ZONES SHOWN ARE THE RESULT OF AN ON THE GROUND SURVEY REFERENCED TO FEMA SPECIFIED BASE FLOOD ELEVATION (ELEVATION = 310' NAVD88).
 - ALL ELEVATIONS REFER TO NAVD88 DATUM.

EROSION CONTROL NOTES

- PRIOR TO THE START OF CONSTRUCTION THE LIMITS OF CLEARING AND TREES NOT INTENDED FOR REMOVAL SHALL BE CLEARLY MARKED IN THE FIELD WITH FLORESCENT FLAGGING BEARING THE LABEL "LIMIT OF CLEARING" OR "TREE TO BE SAVED". AS APPROPRIATE, ALTERATION OF AREAS BEYOND THE DEMARKED LIMITS OF CLEARING IS PROHIBITED.
- PRIOR TO THE BEGINNING OF CONSTRUCTION ALL EROSION CONTROL BARRIERS SHALL BE INSTALLED. THE LOCATIONS SHALL BE STAKED IN THE FIELD BY A REGISTERED PROFESSIONAL ENGINEER OR LAND SURVEYOR AND INSPECTED BY AN AGENT OF THE CONSERVATION COMMISSION.
- NO WORK SHALL BE DONE WITHIN A RESOURCE AREA OR BUFFER ZONE WITHOUT FIRST OBTAINING AN ORDER OF CONDITIONS FROM THE LOCAL CONSERVATION COMMISSION. THE EROSION CONTROL BARRIER DEMARKS THE LIMIT OF WORK.
- SUFFICIENT HAYBALES SHALL BE STOCKED ON SITE AND KEPT FOR EMERGENCIES. PROPOSED EROSION CONTROLS SHALL BE INSPECTED REGULARLY AND REPLACED WHEN NECESSARY.
- A CRUSHED STONE MOUND SHALL BE PLACED THE FULL WIDTH OF THE ENTRANCE WAY, 50 FEET INTO THE SITE AND ONE FOOT DEEP. THIS MOUND SHALL BE MAINTAINED AND REPLACED AS NECESSARY (SEE DETAIL).
- EROSION CONTROL BARRIERS SHALL BE INSPECTED AND MAINTAINED REGULARLY.
- ALL CLEARED AREAS OF THE SITE NOT PLANTED WITH GROUND COVER SHALL BE LOAMED WITH NOT LESS THAN SIX INCHES OF COMPACTED, GOOD QUALITY LOAM AND SEEDED WITH TURF GRASS IN ACCORDANCE WITH GOOD PLANTING PRACTICE.
- CONTRACTOR SHALL KEEP THE STREET CLEAN OF DIRT AND SEDIMENT THAT IS WASHED INTO THE STREET OR TRACKED INTO THE STREET BY CONSTRUCTION VEHICLES. STREET SHALL BE SWEEPED AT THE END OF EACH DAY OF CONSTRUCTION AS NEEDED.

CONSTRUCTION SEQUENCE

- DURING THIS SEQUENCE ALL EROSION CONTROL BARRIERS SHALL BE INSPECTED AND MAINTAINED. ALL DISTURBED AREAS SHALL BE STABILIZED BY WOOD CHIPS, MULCH, SEEDING OR SODDING AS SOON AS AS POSSIBLE AFTER GRADING IS COMPLETE. ALL EROSION CONTROL BARRIERS SHALL BE REMOVED UPON COMPLETION OF FINAL SLOPE STABILIZATION. SITE SHALL BE CONSTRUCTED IN ONE PHASE.
- DEMARK LIMITS OF CLEARING; INSTALL EROSION CONTROL BARRIERS. CONTACT WESTON STORMWATER ENGINEER FOR INSPECTION.
 - CLEAR AND STUMP SITE; STRIP AND STOCKPILE LOAM AND REMOVE ANY DELETERIOUS MATERIALS ENCOUNTERED FROM SITE.
 - INSTALL CRUSHED STONE CONSTRUCTION ENTRANCE.
 - INSTALL DRINKING WATER WELLS.
 - CONSTRUCT DWELLING FOUNDATIONS AND BACKFILL.
 - INSTALL UNDERGROUND ELECTRIC AND TELECOM UTILITIES.
 - CONSTRUCT SEWAGE DISPOSAL SYSTEMS.
 - CONSTRUCTION ROOF INFILTRATION SYSTEMS.
 - GRADE AND COMPACT DRIVEWAY BASE AND PLACE BINDER COURSE OF PAVEMENT.
 - COMPLETE FINAL LANDSCAPING, LOAM AND SEED ALL REMAINING DISTURBED AREAS.
 - CONTACT DESIGN ENGINEER TO CONDUCT AS-BUILT SURVEY OF SITE.
 - FOLLOWING COMPLETION OF CONSTRUCTION, AFTER VEGETATION HAS BEEN WELL ESTABLISHED, CONTACT CONSERVATION COMMISSION FOR FINAL SITE INSPECTION, REQUEST CERTIFICATE OF COMPLIANCE.

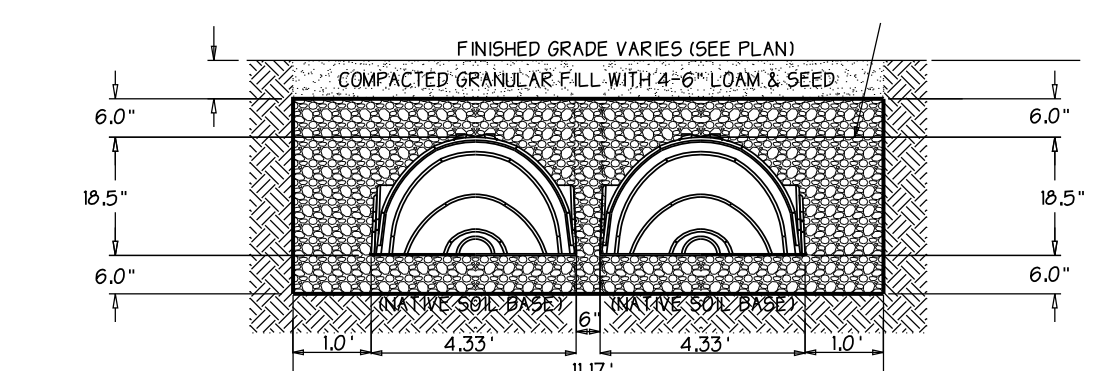

TYPICAL CULTEC RECHARGER R330XLHD ROOF INFILTRATION SYSTEM SECTION (LOTS 2 & 4) NOT TO SCALE

GENERAL NOTES:
 RECHARGER R330XLHD BY CULTEC, INC. OF BROOKFIELD, CT. STORAGE PROVIDER = 7.46 CF/FT DESIGN UNIT. REFER TO CULTEC, INC.'S CURRENT RECOMMENDED INSTALLATION GUIDELINES.
 MAXIMUM ALLOWED COVER OVER TOP OF UNIT SHALL BE 12'-FT. THE CHAMBER WILL BE DESIGNED TO WITHSTAND TRAFFIC LOADS WHEN INSTALLED ACCORDING TO CULTEC'S RECOMMENDED INSTALLATION INSTRUCTIONS.

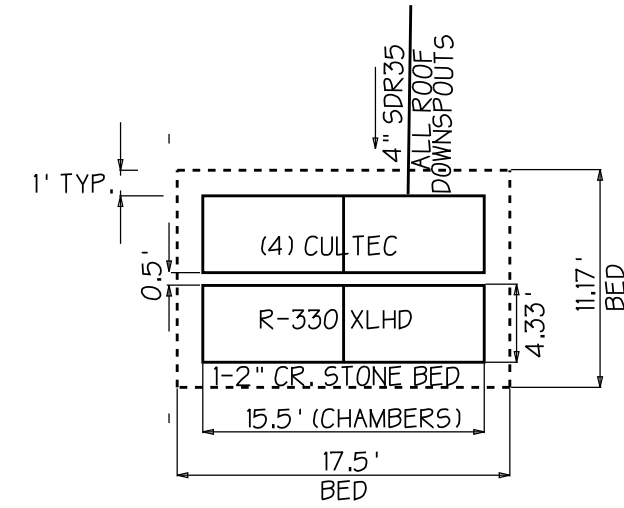

TYP. ROOF INFILTRATION SYSTEM (LOT 2 & 4) NOT TO SCALE

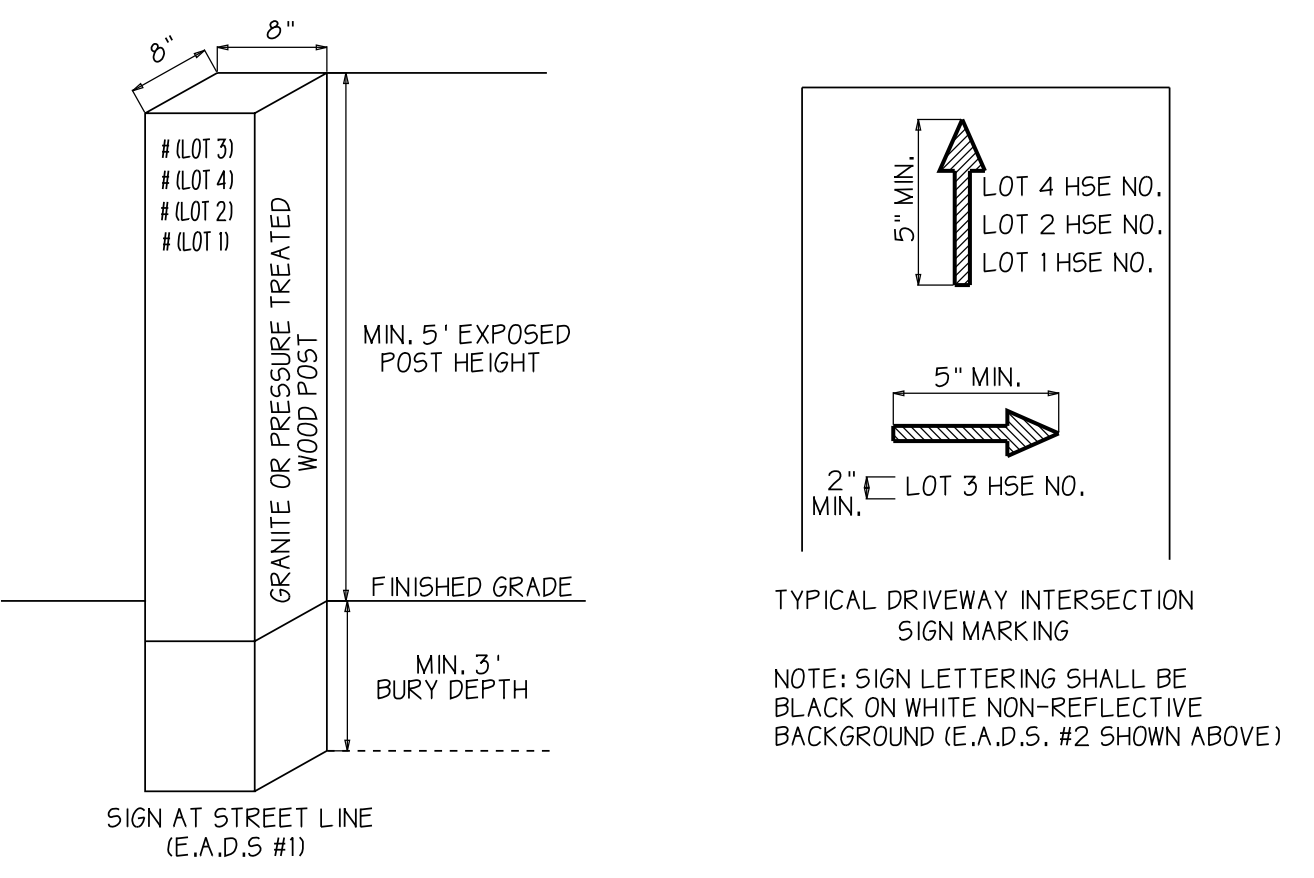

TYPICAL EMERGENCY ACCESS DIRECTION SIGN (E.A.D.S.) NOT TO SCALE

SIGNS TO DIRECT EMERGENCY RESPONSE VEHICLES MUST BE INSTALLED AT STREET LINE AND AT EACH DRIVEWAY INTERSECTION ALONG THE COMMON DRIVEWAY AT LOCATIONS SHOWN. THE SIGN AT THE STREET LINE WILL DESIGNATE ALL ADDRESSES SERVED BY THE COMMON DRIVEWAY. SIGNS AT EACH DRIVEWAY INTERSECTION SHALL INCLUDE ARROWS INDICATING GENERAL DIRECTION TO EACH DWELLING ALONG THE COMMON DRIVEWAY, AS SHOWN TYPICALLY ABOVE. STREET NUMBERS FOR EACH LOT SERVED BY THE COMMON DRIVEWAY SHALL BE ASSIGNED BY THE BOLTON BUILDING INSPECTOR.

SEE SPECIAL PERMIT ISSUED BY BOLTON PLANNING BOARD DATED: _____
 SEE COMMON DRIVEWAY MAINTENANCE AGREEMENT RECORDED AT W.D.R.D. IN BOOK _____ PAGE _____



SLOPE STABILIZATION

- DENUDED SLOPES SHALL NOT BE UNATTENDED OR EXPOSED FOR EXCESSIVE PERIODS OF TIME, SUCH AS THE INACTIVE WINTER SEASON.
- NO LATER THAN OCTOBER 31 OF EACH CALENDAR YEAR, THE DEVELOPER SHALL STABILIZE ALL EXPOSED SOILS AND OTHER VULNERABLE OR SENSITIVE AREAS IN A MANNER ACCEPTABLE TO THE SITE ENGINEER AND CONSERVATION COMMISSION. NO ADDITIONAL DISRUPTION OF THE SITE MAY OCCUR EXCEPT IN ACCORDANCE WITH THE APPROVED CONSTRUCTION PLAN.
- TOPSOIL SHALL HAVE A SANDY LOAM TEXTURE RELATIVELY FREE OF SUBSOIL MATERIAL, STONES, ROOTS, LUMPS OF SOIL, TREE LIMBS, TRASH OR CONSTRUCTION DEBRIS.
- THE SEED MIX SHALL BE INOCULATED WITHIN 24 HOURS BEFORE MIXING AND PLANTING, WITH APPROPRIATE INOCULUM FOR EACH VARIETY.

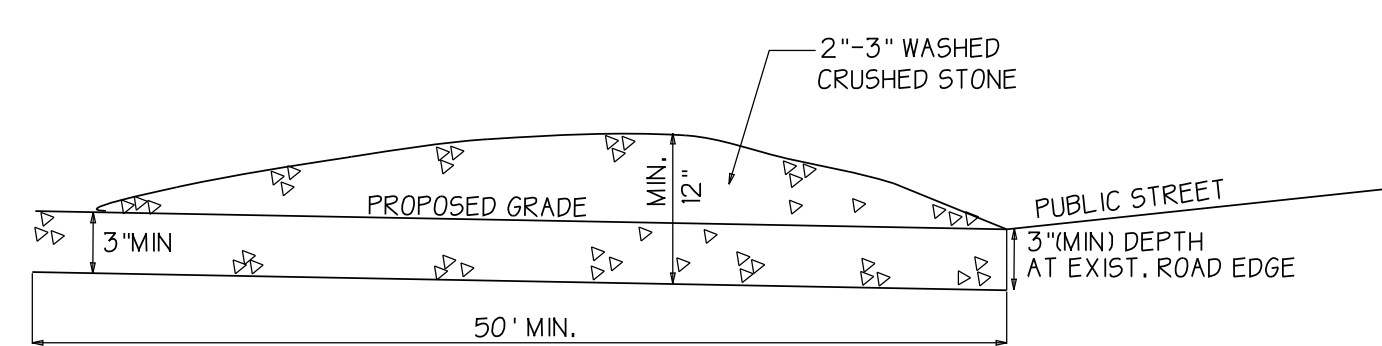

CRUSHED STONE CONSTRUCTION ENTRANCE NOT TO SCALE

NOTE: PURPOSE IS TO REMOVE MUD FROM TIRES AND TO PREVENT EROSION & SEDIMENT FROM ENTERING THE PUBLIC WAY

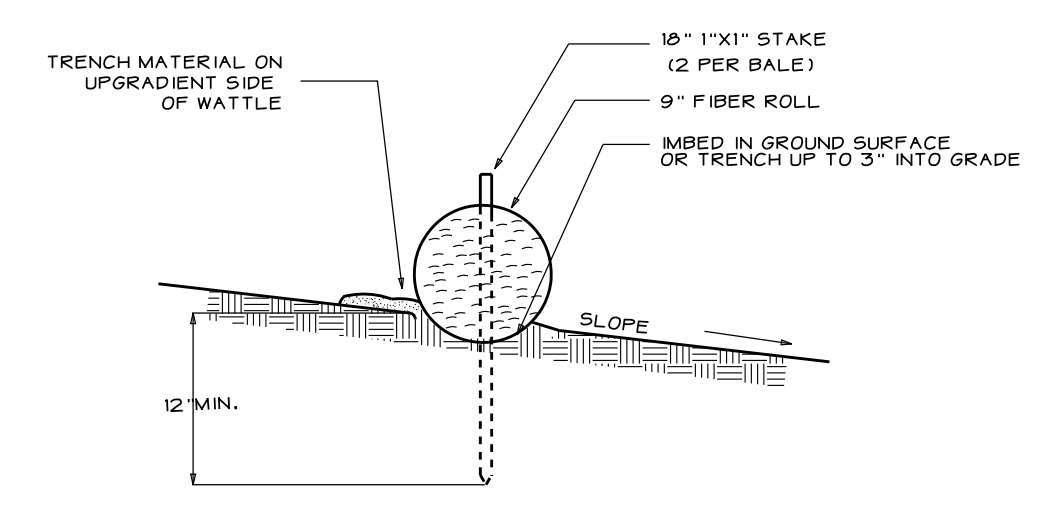

STAKED FIBER ROLL EROSION CONTROL BARRIER NOT TO SCALE (SEE PLAN VIEW FOR PROPOSED LOCATIONS)

COMMON DRIVEWAY PLAN & PROFILE

SHEET 2 OF 2

LOTS 1-4 CENTURY MILL ROAD
 BOLTON, MASSACHUSETTS
 ASSESSORS MAP 3D PARCEL 75

PREPARED FOR:
 21 CENTURY MILL LLC
 291 MAIN STREET SUITE 8
 NORTHBOROUGH, MA 01532

REV. 11/24/20; 1/9/21; 3/19/21; 4/23/21
 DATE: AUGUST 11, 2020 SCALE: AS NOTED

ENGINEERING SURVEYING PLANNING

16 Gleasondale Road Suite 1-1
 Stow, Massachusetts 01775
 Phone: (978)461-2350

www.foresitel.com